

Chill Vents

CATALOG



Casting and Molding Technologies for
Overall Equipment Effectiveness

CHILL VENT selector



VACUUM-ASSIST
OR
PASSIVE VENTING

VACUUM CHILL VENT **VCV**

CHILL VENT **CV**

POCKET STYLE

- A** FLUSH TO BOTTOM
- B** MIDLAND REAR MOUNT STYLE
- B2** MIDLAND VERTICAL MOUNT STYLE
- F** FONDAREX STYLE
- I** OPTIVENT/INTERGUSS STYLE
- N** NGK STYLE

WIDTH

57	57MM	150MM	150
64	64MM	165MM	165
80	80MM	190MM	190
90	90MM	203MM	203
100	100MM	240MM	240
116	116MM	295MM	295
140	140MM		

SERRATION
GEOMETRY

FL FLAT

FLX FLAT LARGE

RX ROUND

VCV

A

140

FL

EXAMPLE P/N

Custom Tooling Components

Style A Chill Vents

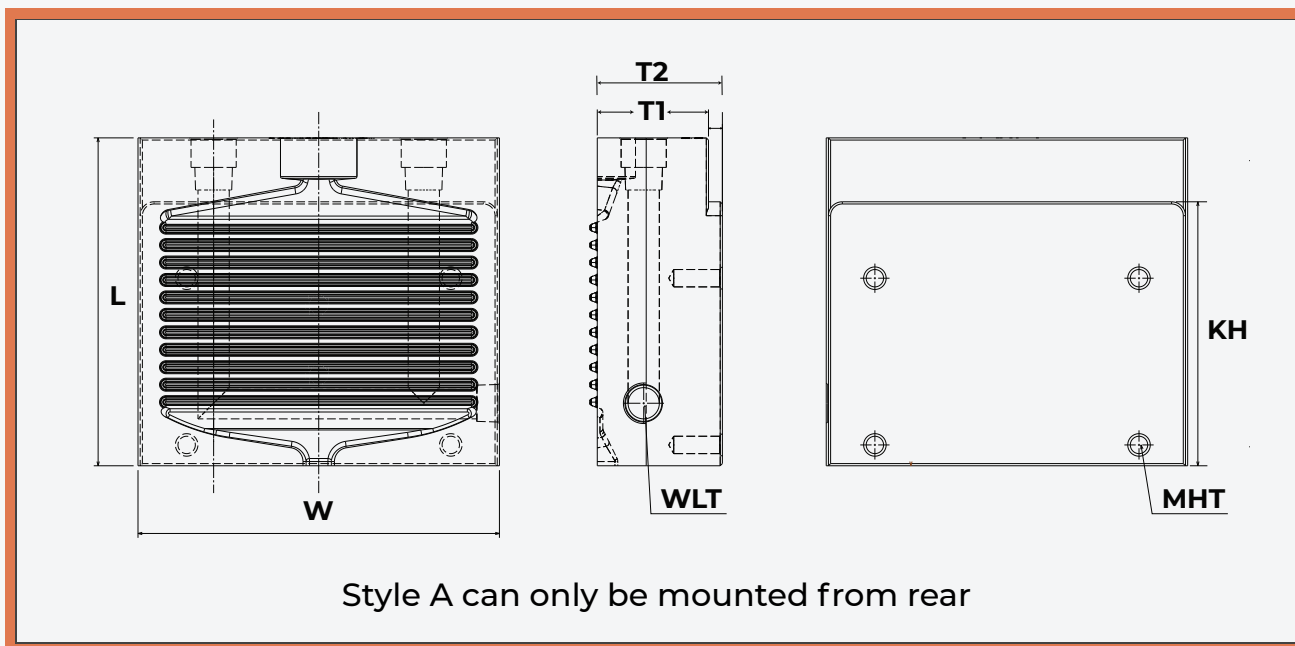

3D models take precedent

For passive vent instead of vacuum-assist, change VCV to CV

	W	L	T1	T2	KH	MHT	WLT
VCV-A-57	2.25	3.54	1.00	1.25	2.70	1/4-20 UNC	1/8 NPT
VCV-A-64	2.50	5.90	2.00	2.34	4.75	1/4-20 UNC	1/4 NPT
VCV-A-100	3.94	5.90	2.00	2.34	4.75	3/8-16 UNC	1/4 NPT
VCV-A-116	4.57	5.90	2.00	2.34	4.75	3/8-16 UNC	1/4 NPT
VCV-A-140	5.51	5.90	2.00	2.34	4.75	3/8-16 UNC	3/8 NPT
VCV-A-165	6.50	5.90	2.00	2.34	4.75	3/8-16 UNC	3/8 NPT
VCV-A-203	8.00	6.40	2.00	2.34	4.75	1/2-13 UNC	3/8 NPT

Style A2 Chill Vents

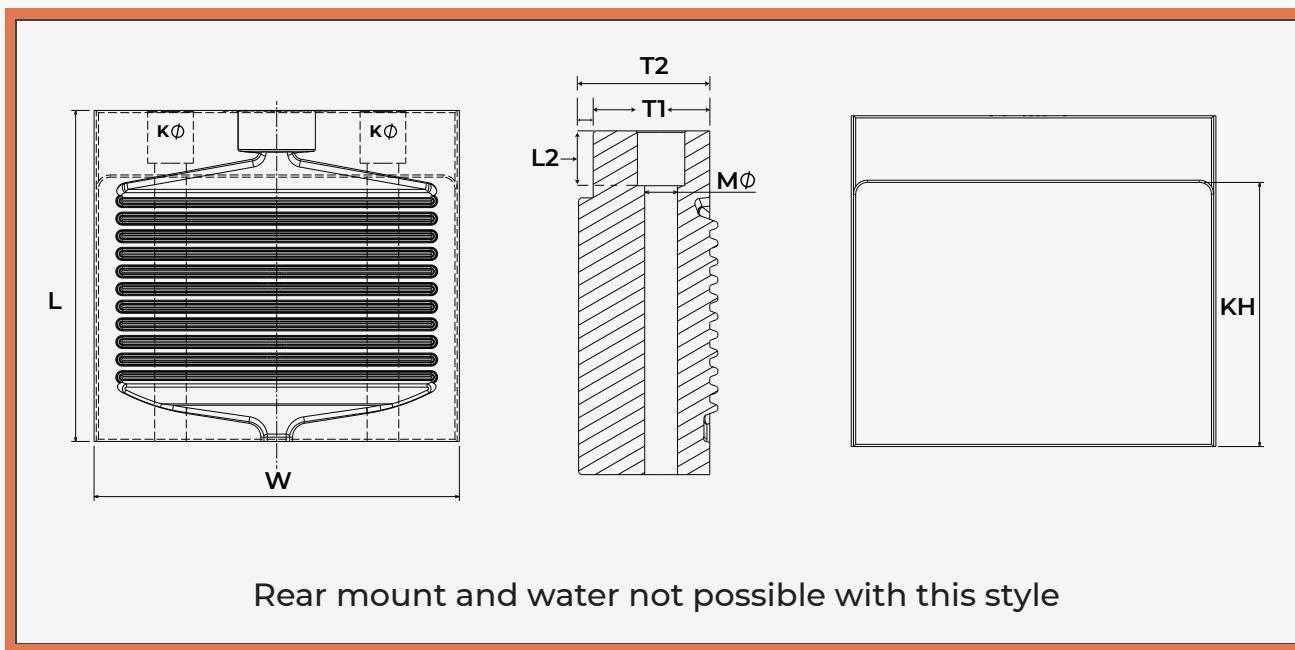

3D model takes precedent

For passive vent instead of vacuum-assist, change VCV to CV

	W	L	T1	T2	KH	KΦ	L2	MΦ
VCV-A2-57	2.25	3.54	1.00	1.25	2.70	0.50	0.36	0.33
VCV-A2-64	2.50	5.90	2.00	2.34	4.75	0.63	0.75	0.43
VCV-A2-100	3.94	5.90	2.00	2.34	4.75	0.63	0.75	0.43
VCV-A2-116	4.57	5.90	2.00	2.34	4.75	0.63	0.75	0.43
VCV-A2-140	5.51	5.90	2.00	2.34	4.75	0.81	0.75	0.56
VCV-A2-165	6.50	5.90	2.00	2.34	4.75	0.81	0.94	0.56
VCV-A2-203	8.00	6.40	2.00	2.34	4.75	0.81	0.94	0.56

Style B Chill Vents

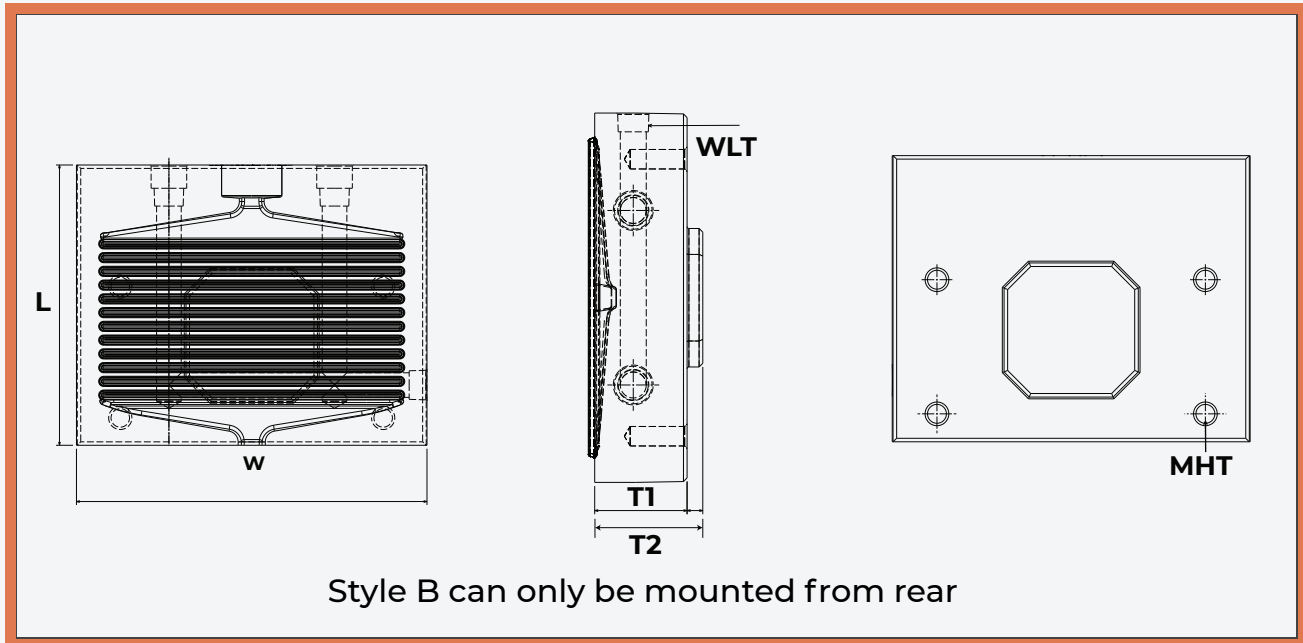

Style B can only be mounted from rear

3D models take precedent

For passive vent instead of vacuum-assist, change VCV to CV

	W	L	T1	T2	MHT	WLT
VCV-B-57	2.25	3.54	1.00	1.25	1/4-20 UNC	1/8 NPT
VCV-B-64	2.50	5.90	2.00	2.34	1/4-20 UNC	1/4 NPT
VCV-B-100	3.94	5.90	2.00	2.34	3/8-16 UNC	1/4 NPT
VCV-B-116	4.57	5.90	2.00	2.34	3/8-16 UNC	1/4 NPT
VCV-B-140	5.51	5.90	2.00	2.34	3/8-16 UNC	3/8 NPT
VCV-B-165	6.50	5.90	2.00	2.34	3/8-16 UNC	3/8 NPT
VCV-B-203	8.00	6.40	2.00	2.34	1/2-13 UNC	3/8 NPT

Style B2 Chill Vents

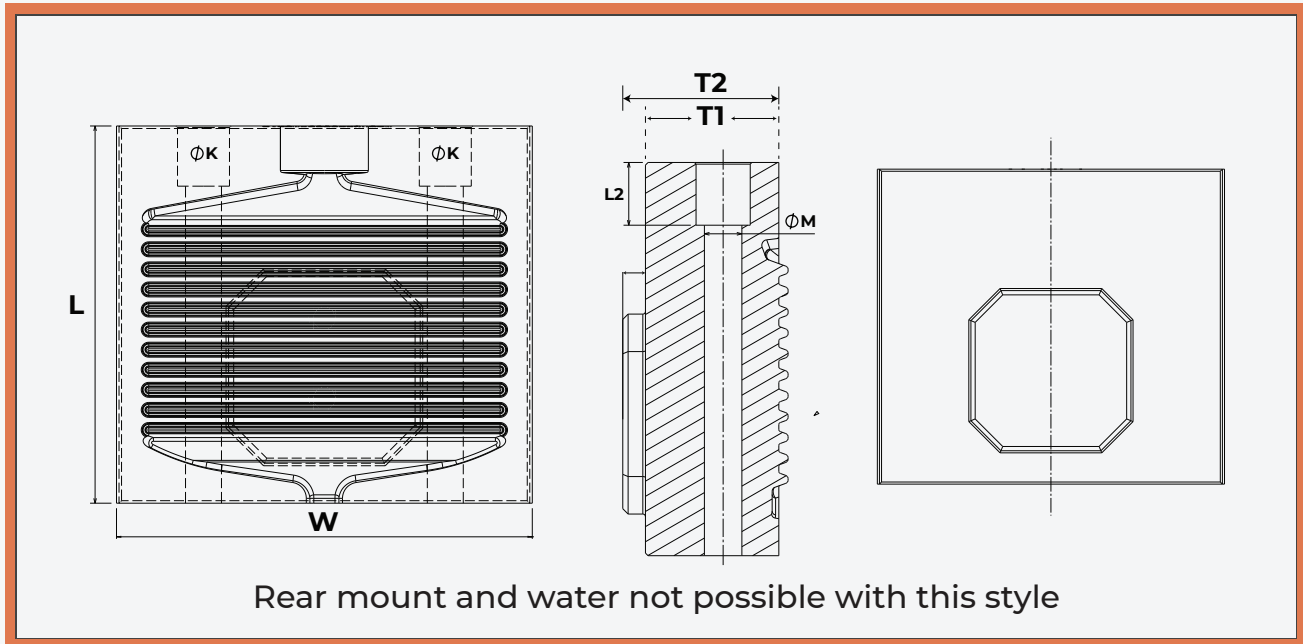

3D models take precedent

For passive vent instead of vacuum-assist, change VCV to CV

	W	L	T1	T2	K ϕ	L2	M ϕ
VCV-B2-57	2.25	3.54	1.00	1.25	0.50	0.36	0.33
VCV-B2-64	2.50	5.90	2.00	2.34	0.63	0.75	0.43
VCV-B2-100	3.94	5.90	2.00	2.34	0.63	0.75	0.43
VCV-B2-116	4.57	5.90	2.00	2.34	0.63	0.75	0.43
VCV-B2-140	5.51	5.90	2.00	2.34	0.81	0.75	0.56
VCV-B2-165	6.50	5.90	2.00	2.34	0.81	0.94	0.56
VCV-B2-203	8.00	6.40	2.00	2.34	0.81	0.94	0.56

Style F Chill Vents

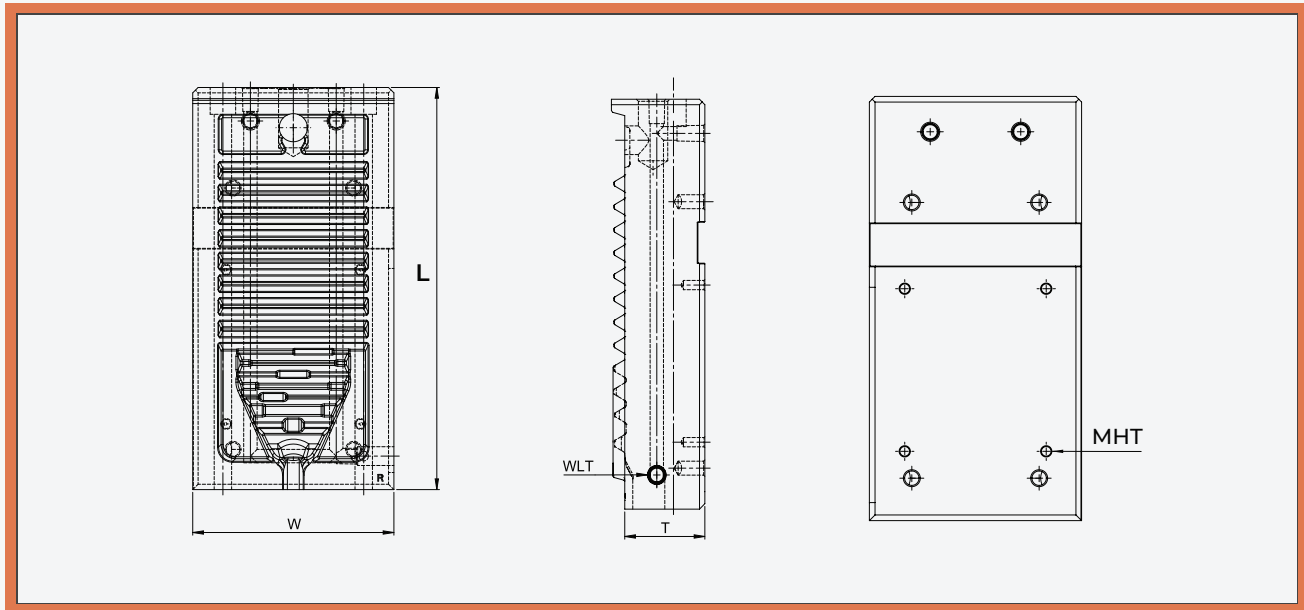

3D model takes precedent

For passive vent instead of vacuum-assist, change VCV to CV

	W(mm)	L(mm)	T(mm)
VCV-F- 100	100.00	250.00	50.00
VCV-F- 140	140.00	300.00	60.00
VCV-F- 150	150.00	360.00	80.00

Style I Chill Vents

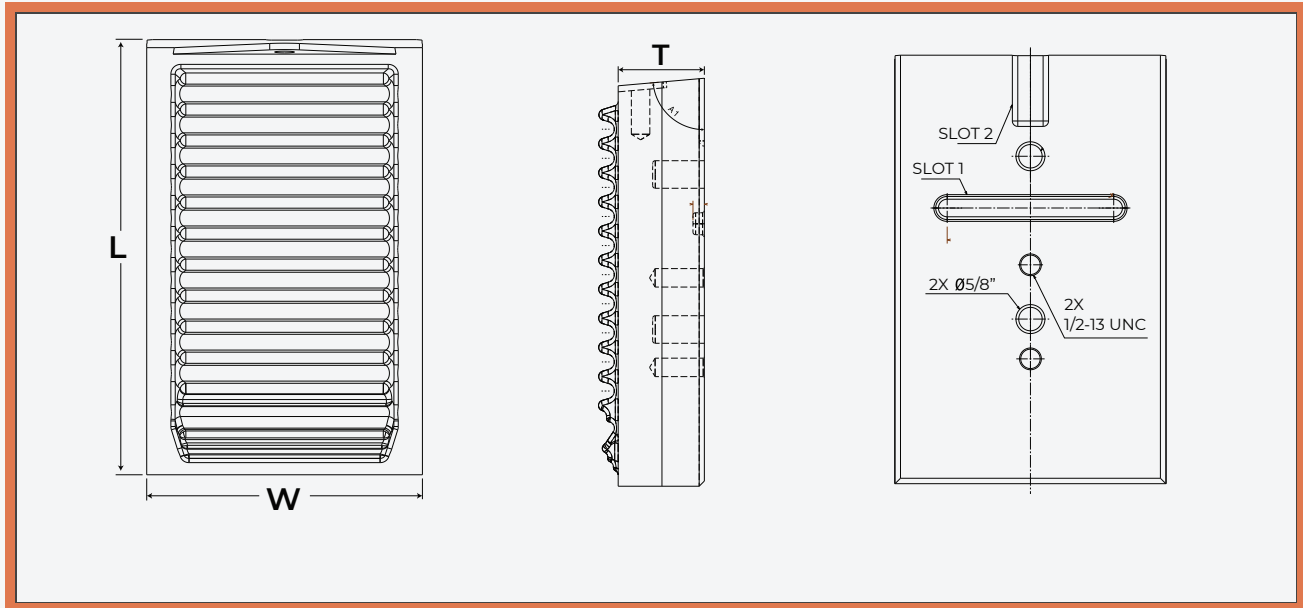

3D model takes precedent

For passive vent instead of vacuum-assist, change VCV to CV

	W(mm)	L(mm)	T(mm)
VCV-I- 50	50	120	50
VCV-I- 60	60	120	50
VCV-I- 70	70	150	50
VCV-I- 80	80	150	50
VCV-I- 100	100	232	50
VCV-I- 120	120	232	50
VCV-I- 130	130	232	50
VCV-I- 140	140	232	50
VCV-I- 150	150	232	50
VCV-I- 180	180	232	50
VCV-I- 240	240	232	50

Style N Chill Vents

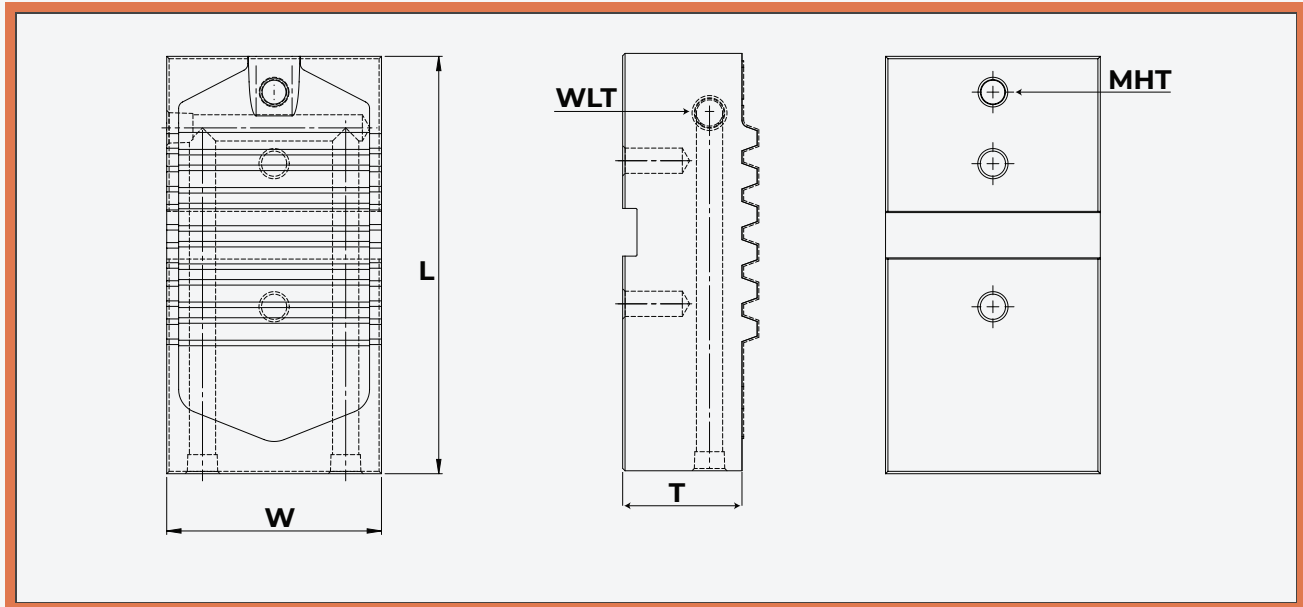

3D model takes precedent

For passive vent instead of vacuum-assist, change VCV to CV

	W(mm)	L(mm)	T(mm)	WLT	MHT
VCV-N- 80	80	135	50	1/4-18 NPT	5/16-18 UNC
VCV-N- 90	90	175	50	1/4-18 NPT	1/2-13 UNC
VCV-N- 100	100	185	50	1/4-18 NPT	1/2-13 UNC

PRODUCT
CATALOG

Custom Core Pins

Replacement Cavities

Custom Chill Vents

Jet Coolers

Ejection Pins & Sleeves

Guide Pins & Bushings

Die Springs & Cascades

Tool Design

Flow Simulations

(612) 440-5714

jasons@oeecompanies.com

www.oeecompanies.com